

LIVERNOIS AVENUE DETOUR MAP

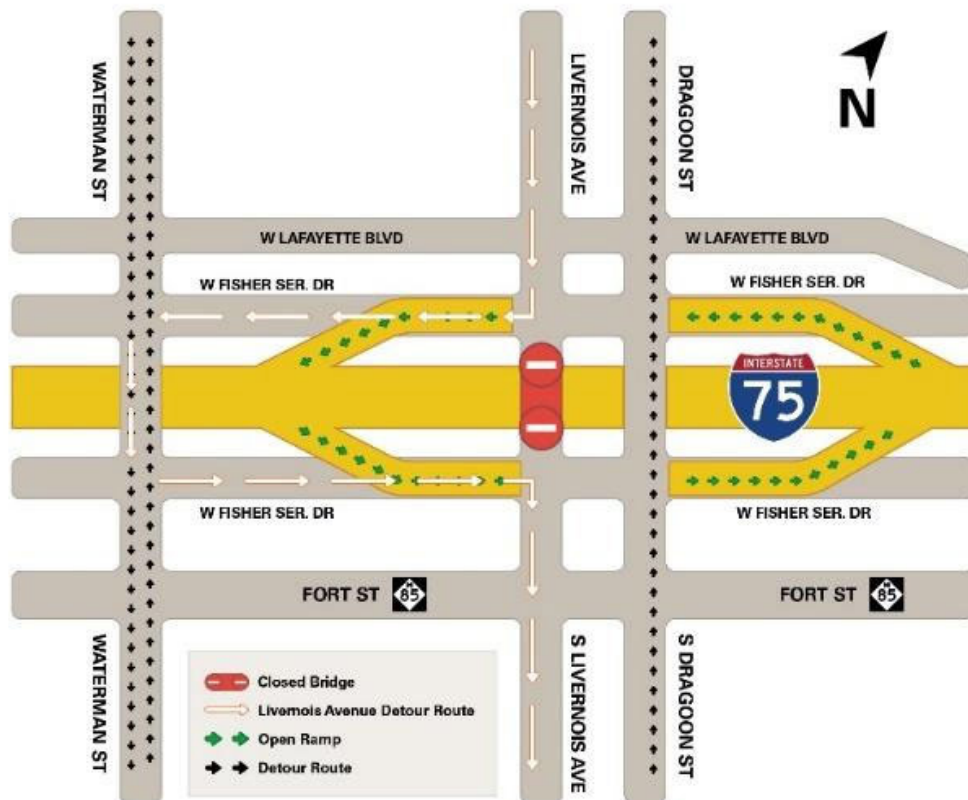

Road Closures

Livernois Avenue road bridge area closures (fall 2019 – winter 2020):

- Livernois Avenue, including the crossing bridge, from the south edge of southbound I-75
- West Fisher Service Drive south to the northern boundary of northbound I-75 West Fisher Service Drive
- I-75 southbound shoulder from 100 ft west to 100 ft east of Livernois Avenue crossing bridge, and from 500 ft west to 900 ft east of Clark Street
- I-75 northbound shoulder from 600 ft west to 300 ft east of Livernois Avenue crossing bridge, and from 700 ft west to 600 ft east of Clark Street.

NOTE: West Fisher Service Drive sections in this area will remain open through Phase 1 of construction.

Detours

Livernois Avenue road bridge detours

Work on the Livernois Avenue crossing bridge will start in fall 2019 and end in winter 2020. Nearby road crossing bridges at Green Street, Waterman Street, Dagoon Street (one-way, northbound), and Junction Street will remain open during this phase. Livernois Avenue will be partially reconstructed from M-85/Fort Street north to I-75 during this phase.

Construction Activities

Livernois Avenue construction activities

Work on the Livernois Avenue crossing bridge will begin in fall 2019 and is anticipated to last until winter 2020. Nearby road crossing bridges at Green Street, Waterman Street, Dagoon Street (one-way, northbound), and Junction Street will remain open during this phase. Livernois Avenue will be partially reconstructed from M-85/Fort Street north to I-75 during this phase.